

CADENAS DE TRANSMISIÓN EJES PROLONGADOS

Cadenas DIN-8187 y DIN-8188

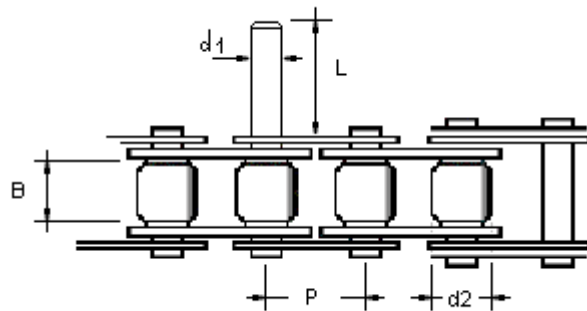

Ref.	Paso	Ancho Inter. B	Ø Rodillo d2	Ø Eje d1	Corto	Normal	Largo
					L	L	L
081	12,7	4,88	7,75	4,09	9,5	15	25
08B-1	12,7	7,75	8,51	4,45	9,5	15	29,5
10B-1	15,875	9,65	10,16	5,08	12	18	34,5
12B-1	19,05	11,68	12,07	5,72	14,5	21	40
16B-1	25,4	17,02	15,88	8,27	19,1	33	65
20B-1	31,75	19,56	19,05	10,16	--	38	75
24B-1	38,1	25,4	25,4	14,63	--	51	100

Ref.	Paso	Ancho Inter. B	Ø Rodillo d2	Ø Eje d1	Corto	Normal	Largo
					L	L	L
10A-1	15,875	9,53	10,16	5,08	12	19	37
12A-1	19,05	12,7	11,91	5,94	14,5	24	47
16A-1	25,4	15,88	15,88	7,92	19,1	31	60
20A-1	31,75	19,05	19,05	9,53	--	42	78
24A-1	38,1	25,4	22,23	11,1	--	52	97

CADENAS DE TRANSMISIÓN

Serie ISO / R606 Norma Europea BS 228 DIN 8187 Cadenas Simples, Dobles y Triples

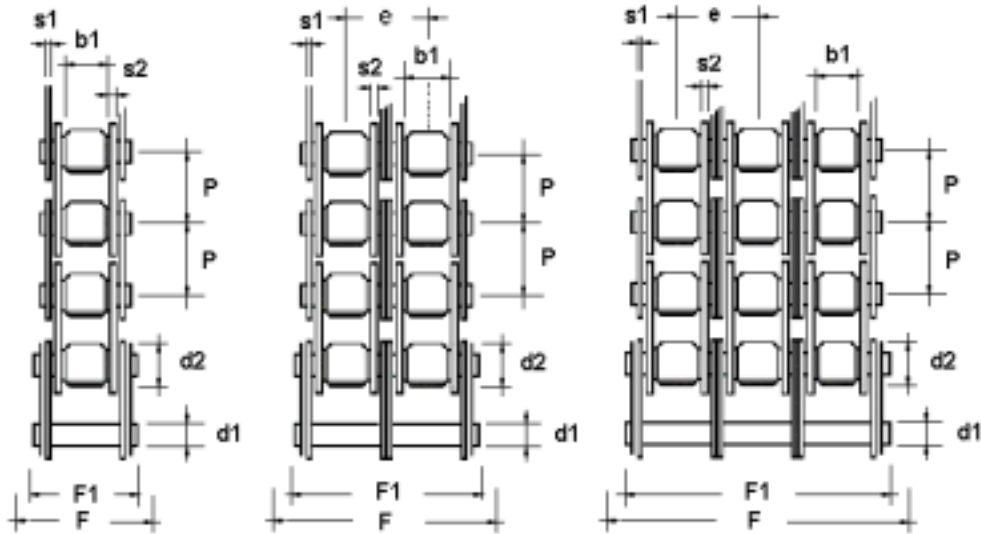

Ref. ISO	PASO (mm.) P	PASO (pulg.) P	Ancho Interior b1	Ø Rod. d2	Ø Eje d1	Grueso Mallas		Ancho Entre Filas e	Ancho max. S/ejes F1	Ancho total cadena F	Superf. Articul. cm2.	Carga de Rotura Kp.	Peso por metro Kg/mtr.
						S1	S2						
05B-1	8	0,315	3	5	2,31	0,73	0,73	--	8,50	11,00	0,10	550	0,18
06B-1	9,525	3/8	5,72	6,35	3,28	1,04	1,30	--	12,40	17,50	0,285	1.000	0,40
08B-1	12,70	1/2	7,75	8,51	4,45	1,50	1,50	--	17,00	20,50	0,50	2.000	0,72
081	12,70	1/2	3,30	7,75	3,66	0,95	1,10	--	9,70	15,40	0,21	1.000	0,28
083	12,70	1/2	4,88	7,75	3,66	0,95	1,10	--	12,30	17,50	0,34	1.400	0,43
10B-1	15,875	5/8	9,65	10,16	5,08	1,60	1,60	--	19,00	24,50	0,68	2.500	0,96
12B-1	19,05	3/4	11,68	12,07	5,72	1,80	1,80	--	22,00	28,00	0,90	3.200	1,23
16B-1	25,40	1	17,02	15,88	8,27	3	4	--	34,60	44,50	2,12	6.500	2,67
20B-1	31,75	1 1/4	19,56	19,05	10,19	3,60	4,62	--	40,10	58,50	2,94	10.000	3,32
24B-1	38,1	1 1/2	25,40	25,40	14,63	5	6,10	--	53,20	76,00	5,54	19.000	7,68
28B-1	44,45	1 3/4	30,99	27,94	15,90	6,35	7,60	--	64,60	90,00	7,40	21.000	9,45
32B-1	50,80	2	30,99	29,21	17,81	6,35	7,10	--	64,40	95,50	8,00	26.000	8,95
40B-1	63,50	2 1/2	38,10	39,37	22,89	8,64	8,13	--	78,40	113,00	12,75	43.000	16,04
05B-2	8	0,315	3	5	2,31	0,73	0,73	5,64	14,20	18,40	0,20	1.050	0,35
06B-2	9,525	3/8	5,72	6,35	3,28	1,04	1,30	10,24	22,70	28,00	0,57	1.900	0,78
08B-2	12,70	1/2	7,75	8,51	4,45	1,50	1,50	13,92	31,00	36,00	1,00	3.800	1,40
10B-2	15,875	5/8	9,65	10,16	5,08	1,60	1,60	16,59	35,70	42,50	1,36	4.750	1,82
12B-2	19,05	3/4	11,68	12,07	5,72	1,80	1,80	19,46	41,50	49,50	1,80	6.100	2,44
16B-2	25,40	1	17,02	15,88	8,27	3	4	31,88	66,50	79,50	4,24	12.400	5,30
20B-2	31,75	1 1/4	19,56	19,05	10,19	3,60	4,62	36,45	76,50	92,50	5,88	19.000	6,59
24B-2	38,1	1 1/2	25,40	25,40	14,63	5	6,10	48,36	101,60	129,00	11,08	36.100	15,24
28B-2	44,45	1 3/4	30,99	27,94	15,90	6,35	7,60	59,56	124,20	156,00	14,80	40.000	18,80
32B-2	50,80	2	30,99	29,21	17,81	6,35	7,10	58,55	123,00	160,00	16,00	49.400	17,810
40B-2	63,50	2 1/2	38,10	39,37	22,89	8,64	8,13	72,29	150,70	193,00	25,50	81.800	31,60
06B-3	9,525	3/8	5,72	6,35	3,28	1,04	1,30	10,24	32,90	39,50	0,85	2.800	1,14
08B-3	12,70	1/2	7,75	8,51	4,45	1,50	1,50	13,92	45,00	51,50	1,50	5.600	2,07
10B-3	15,875	5/8	9,65	10,16	5,08	1,60	1,60	16,59	52,30	61,00	2,05	7.000	2,85
12B-3	19,05	3/4	11,68	12,07	5,72	1,80	1,80	19,46	60,90	70,50	2,70	9.000	3,63
16B-3	25,40	1	17,02	15,88	8,27	3	4	31,88	98,40	114,50	6,36	18.200	7,90
20B-3	31,75	1 1/4	19,56	19,05	10,19	3,60	4,62	36,45	112,90	138,50	8,82	28.000	9,86
24B-3	38,1	1 1/2	25,40	25,40	14,63	5	6,10	48,36	149,90	182,00	16,62	53.200	22,79
28B-3	44,45	1 3/4	30,99	27,94	15,90	6,35	7,60	59,56	183,80	221,50	22,20	58.800	28,06
32B-3	50,80	2	30,99	29,21	17,81	6,35	7,10	58,55	181,50	224,00	24,00	72.800	26,58
40B-3	63,50	2 1/2	38,10	39,37	22,89	8,64	8,13	72,29	223,00	272,00	38,25	120.000	47,16

CADENAS DE EJES HUECOS

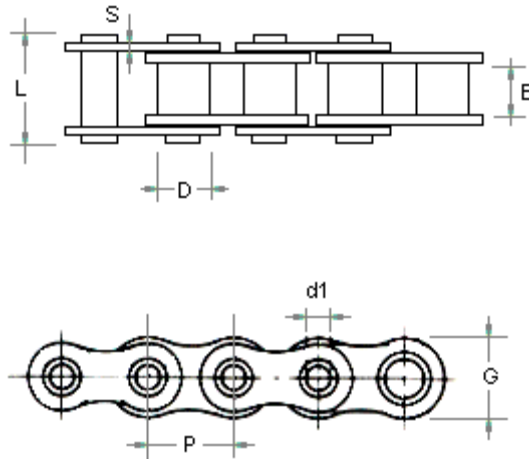

Ref. Cadena	PASO P	Ancho Int. B	Ø Rod. D	Ø Eje Hueco d1	Mallas		L	Superf. De Articul. cm2	Carga De Rotura	Peso Aprox. Kg/mtr.
					G	S				
127	12,7	7,75	8,51	4,4	12,3	1,5	16,5	0,670	1300	0,60
158	15,875	9,52	10,16	5,1	14,5	1,6	20,5	1,050	2000	0,88
190	19,05	11,68	12,07	5,7	16,4	1,8	25	1,560	2700	1,10
254	25,4	17,02	15,88	8,3	22,5	3-4	32,5	2,600	4500	

CADENAS DE TRANSMISIÓN

Serie ASA Norma Americana ANSI B 29.1 DIN 8188 Cadenas Simples, Dobles y Triples

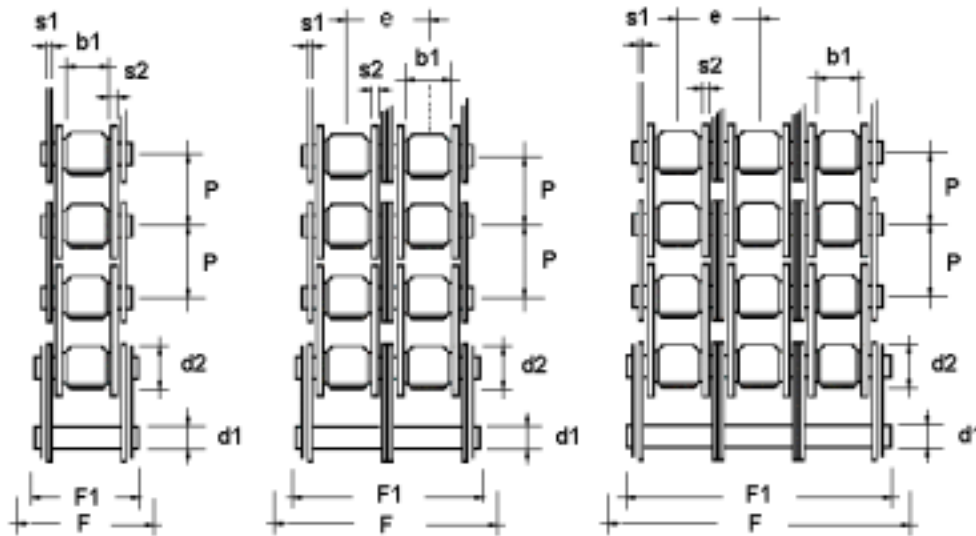

Ref. ASA	PASO (mm.) P	PASO (pulg.) P	Ancho Interior b1	Ø Rod. d2	Ø Eje d1	Grueso Mallas		Ancho Entre Filas e	Ancho max. S/ejes F1	Ancho total cadena F	Superf. Articul. cm2.	Carga de Rotura Kp.	Peso por metro Kg/mtr.
						S1	S2						
04C	6,35	1/4	3,18	3,30	2,30	0,73	0,73	--	8,00	12,50	0,11	450	0,140
06C	9,525	3/8	4,77	5,08	3,59	1,25	1,25	--	11,90	17,50	0,27	1050	0,330
08A-1	12,70	1/2	7,95	7,92	3,96	1,50	1,50	--	16,30	21,50	0,45	1850	0,640
10A-1	15,875	5/8	9,53	10,16	5,08	2,00	2,00	--	20,10	26,50	0,71	2900	1,060
12A-1	19,05	3/4	12,70	11,91	5,94	2,40	2,40	--	28,00	32,00	0,97	3900	1,580
16A-1	25,4	1	15,88	15,88	7,92	3,20	3,20	--	35,30	44,50	1,76	6700	2,610
20A-1	31,75	1 1/4	19,05	19,05	9,53	4,20	4,20	--	43,40	55,50	2,58	11000	3,800
24A-1	38,10	1 1/2	25,40	22,23	11,10	4,80	4,80	--	53,40	67,00	3,90	15500	5,550
28A-1	44,45	1 3/4	25,40	25,40	12,70	5,60	5,60	--	56,40	74,00	4,67	21000	7,700
32A-1	50,80	2	31,75	28,58	14,27	6,30	6,30	--	68,50	85,50	6,40	26500	10,000
40A-1	63,50	2 1/2	38,10	39,67	19,84	8,00	8,00	--	76,50	111,00	10,85	43000	16,690
06C-2	9,525	3/8	4,77	5,08	3,59	1,25	1,25	10,13	22,00	28,50	0,54	2100	0,650
08A-2	12,70	1/2	7,95	7,92	3,96	1,50	1,50	14,38	30,70	37,50	0,90	3700	1,280
10A-2	15,875	5/8	9,53	10,16	5,08	2,00	2,00	18,11	38,20	46,50	1,42	5800	2,100
12A-2	19,05	3/4	12,70	11,91	5,94	2,40	2,40	22,78	51,20	57,00	1,94	7800	3,150
16A-2	25,4	1	15,88	15,88	7,92	3,20	3,20	29,29	61,40	77,00	3,60	13400	5,190
20A-2	31,75	1 1/4	19,05	19,05	9,53	4,20	4,20	35,76	79,20	95,00	5,16	22000	7,700
24A-2	38,10	1 1/2	25,40	22,23	11,10	4,80	4,80	45,44	98,90	117,00	7,80	31000	11,100
28A-2	44,45	1 3/4	25,40	25,40	12,70	5,60	5,60	48,87	105,40	128,00	9,34	42000	15,400
32A-2	50,80	2	31,75	28,58	14,27	6,30	6,30	58,55	127,10	150,00	12,80	53000	20,000
40A-2	63,50	2 1/2	38,10	39,67	19,84	8,00	8,00	71,55	148,00	190,00	21,70	86000	33,000
06C-3	9,525	3/8	4,77	5,08	3,59	1,25	1,25	10,13	32,20	39,50	0,81	3150	0,950
08A-3	12,70	1/2	7,95	7,92	3,96	1,50	1,50	14,38	45,10	53,50	1,35	5550	1,900
10A-3	15,875	5/8	9,53	10,16	5,08	2,00	2,00	18,11	56,30	66,50	2,13	8700	3,140
12A-3	19,05	3/4	12,70	11,91	5,94	2,40	2,40	22,78	70,70	82,00	2,91	11700	4,710
16A-3	25,4	1	15,88	15,88	7,92	3,20	3,20	29,29	90,60	110,00	5,28	20100	7,760
20A-3	31,75	1 1/4	19,05	19,05	9,53	4,20	4,20	35,76	115,00	134,00	7,74	33000	11,500
24A-3	38,10	1 1/2	25,40	22,23	11,10	4,80	4,80	45,44	144,40	167,00	11,70	46500	16,600
28A-3	44,45	1 3/4	25,40	25,40	12,70	5,60	5,60	48,87	154,30	181,50	18,00	63000	23,000
32A-3	50,80	2	31,75	28,58	14,27	6,30	6,30	58,55	185,60	214,50	19,20	79500	30,000
40A-3	63,50	2 1/2	38,10	39,67	19,84	8,00	8,00	71,55	219,50	268,00	32,55	129000	49,310

CADENAS DE TRANSMISIÓN

Serie ISO Norma Europea DIN 8187
ACCESORIOS NORMALIZADOS 08B-1 (12,7)

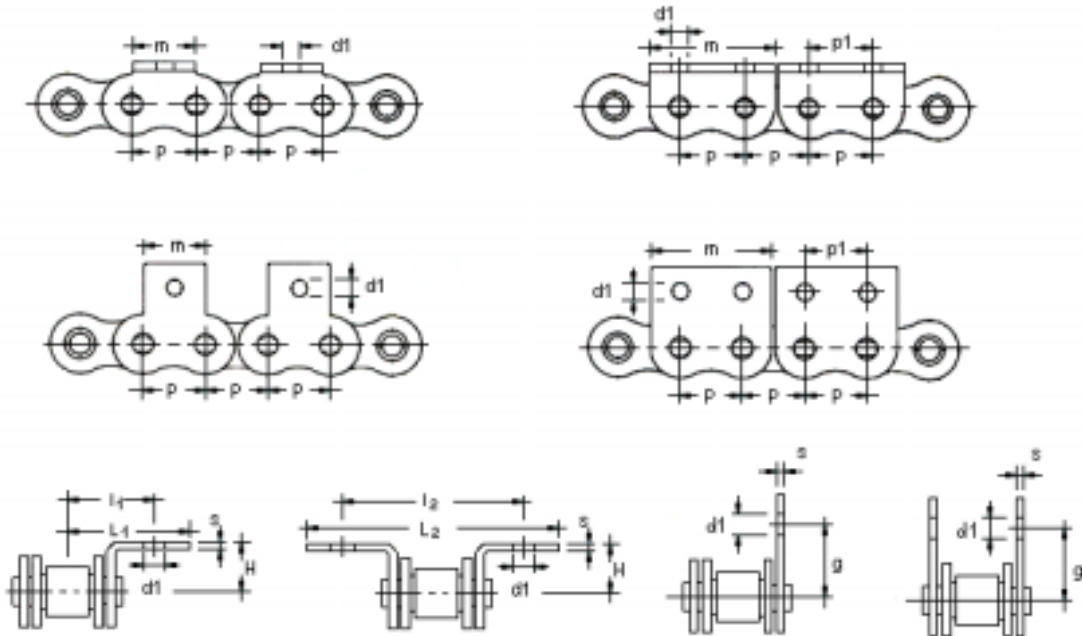

ACCESORIOS NORMALIZADOS DISPONIBLES PARA CADENA 08B (Paso 12,7 mm.)

Ref. Accesorio	Tipo	Nº Taladros	Ø D1	p2	m	H	l1	l2	L1	L2	g	S
08B1.41	Recta	1	4,3	--	10,2	--	--	--	--	--	12,7	1,5
08B1.42	Recta	2	4,3	12,7	24,3	--	--	--	--	--	12,7	1,5
08B1.61	90°	1	4,3	--	10,2	8,9	12,7	25,4	17,6	35,2	--	1,5
08B1.62	90°	2	4,3	12,7	24,3	8,9	12,7	25,4	19,3	38,6	--	1,5
08B1.64	90°	Ciega	--	--	24,3	8,9	--	--	19,5	39	--	1,5
08B1.66	90°	Ciega	--	--	19,6	10,3	--	--	19,8	39,6	--	1,5
08B1.67	90°	1	4,25	--	24	7,5	14,3	28,6	19,3	38,6	--	1,5
08B1.68	90°	1	4,3	--	10,2	8,5	14	28	19,1	38,2	--	1,5
08B1.69	Recta	1	4,3	--	10,2	--	--	--	--	--	14	1,5
08B1.70	90°	1	5,2	--	17,5	8	13,7	27,4	19,9	39,8	--	1,5
08B1.71	90°	Ciega	--	--	20	10	--	--	16,3	32,6	--	1,5
08B1.73	90°	Ciega	--	--	19,6	8,9	--	--	21	42	--	1,5
08B1.75	90°	1	4,3	--	20	8,9	12,9	25,8	18,9	37,8	--	1,5
08B1.92	Recta	1	5,5	--	10,2	--	--	--	--	--	13,3	1,5
08B1.43	PINCHO		--	--	5,5	--	--	--	--	--	--	1,5
08B1.43AFIL	PINCHO AFILADA		--	--	5,5	--	--	--	--	--	--	1,5
08B1.48	PINCHO ANCHA		--	--	5	--	--	--	--	--	--	1,5
08B1.63	PROTUBERANCIA		--	--	20	8,9	12,7	25,4	19,4	38,8	--	1,5
08B1.45	ESCOTE 90°		--	--	--	--	--	--	--	--	--	1,5

CADENAS DE TRANSMISIÓN

Serie ISO Norma Europea DIN 8187

ACCESORIOS DIVERSOS 08B (12,7)

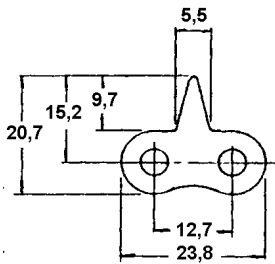

08B1.43

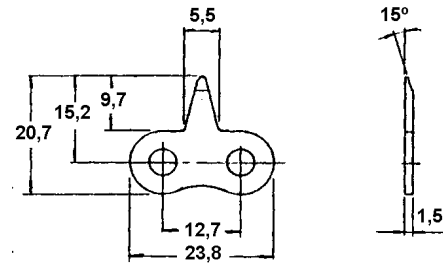

08B1.43 AFILADA

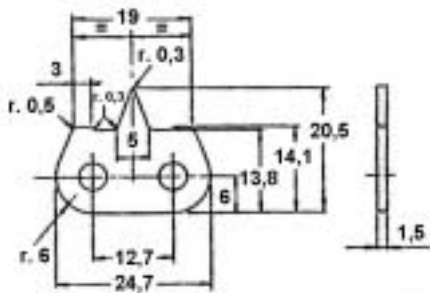

08B1.48

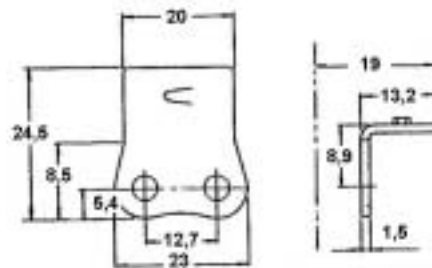

08B1.63

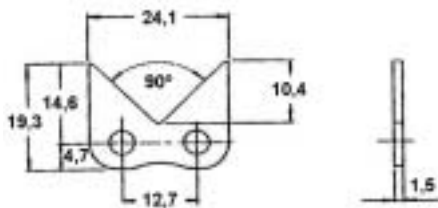

08B1.45

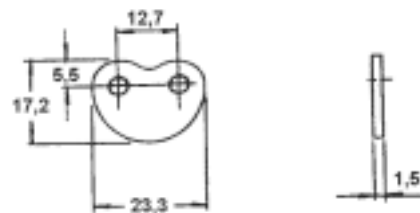

08B1.72

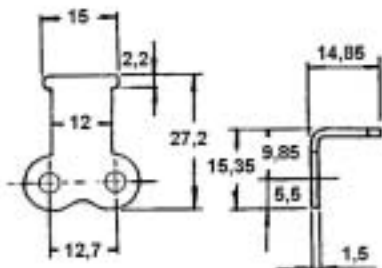

08B1.74

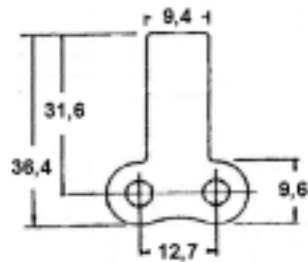

N° 1127-A

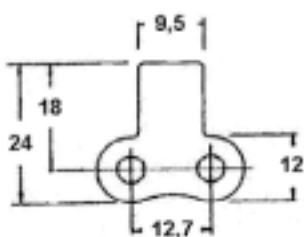

N° 79

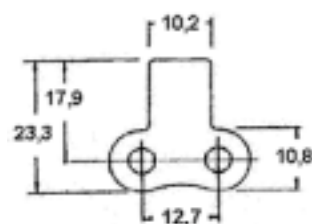

N° 287

CADENAS DE TRANSMISIÓN

Serie ISO Norma Europea DIN 8187

ACCESORIOS DIVERSOS 08B (12,7)

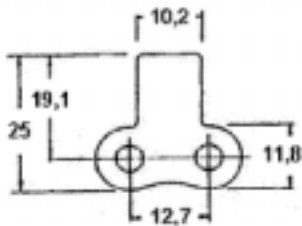

N° 283

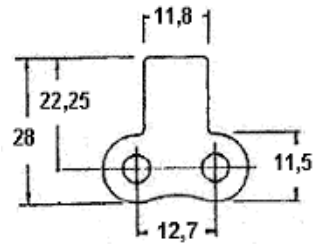

N° 217

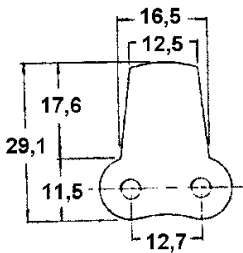

N° 364

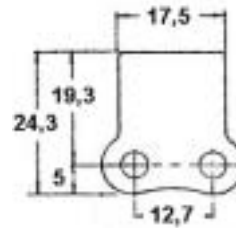

N° 371

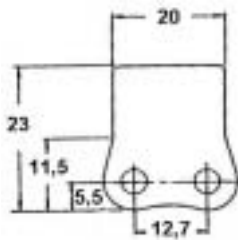

N° 370

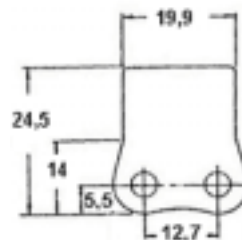

N° 569

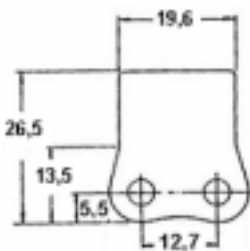

N° 372

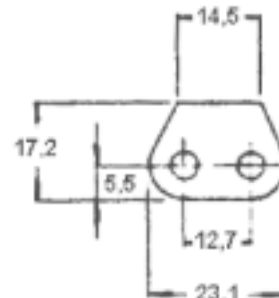

N° 1127-B

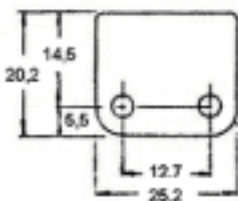

N° 132

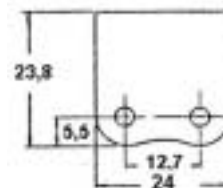

N° 373

CADENAS DE TRANSMISIÓN

Serie ISO Norma Europea DIN 8187

ACCESORIOS DIVERSOS 08B (12,7)

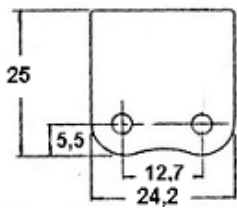

Nº 227

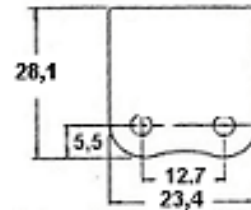

Nº 121

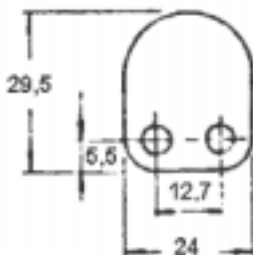

Nº 127

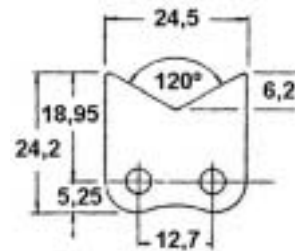

Nº 684

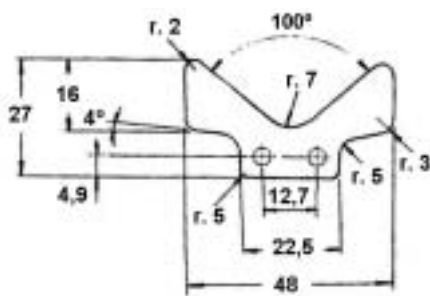

Nº 7251

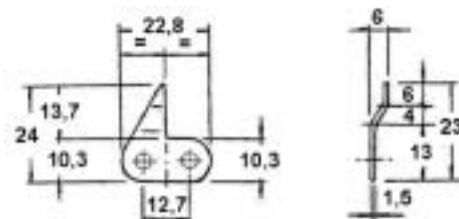

Nº 372

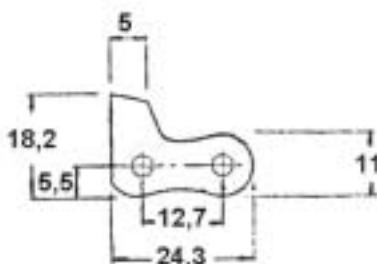

Nº 135

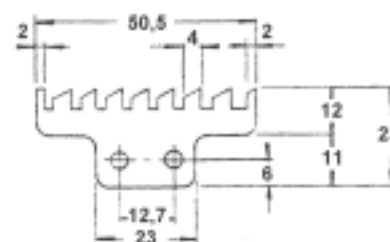

Nº 570

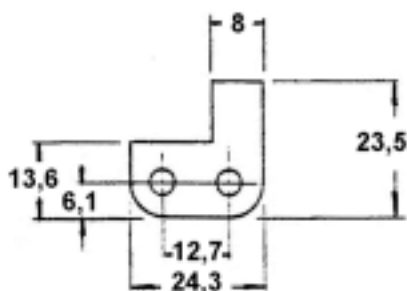

Nº 9672

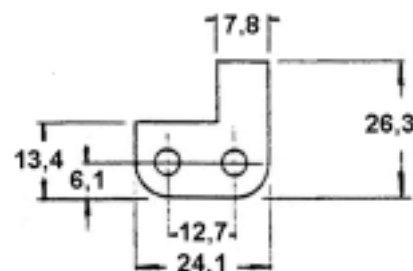

Nº 12214

CADENAS DE TRANSMISIÓN

Serie ISO Norma Europea DIN 8187
ACCESORIOS DIVERSOS 08B (12,7)

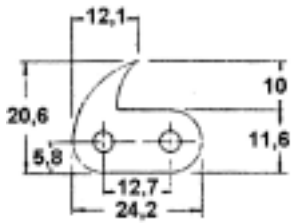

Nº 666

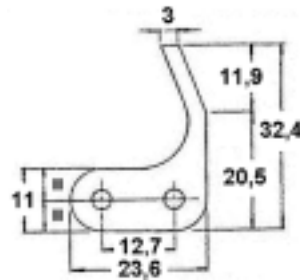

Nº 599

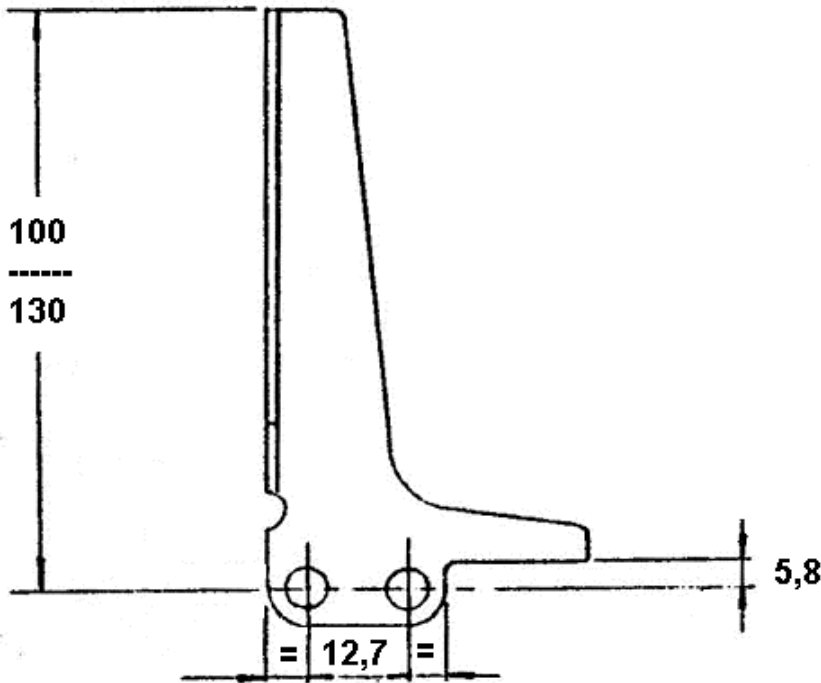

Nº 8063

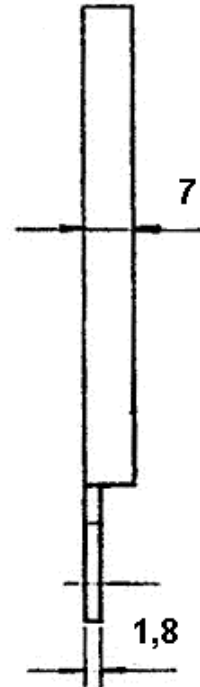

CADENAS DE TRANSMISIÓN

Serie ISO Norma Europea DIN 8187

ACCESORIOS NORMALIZADOS 10B (15,875)

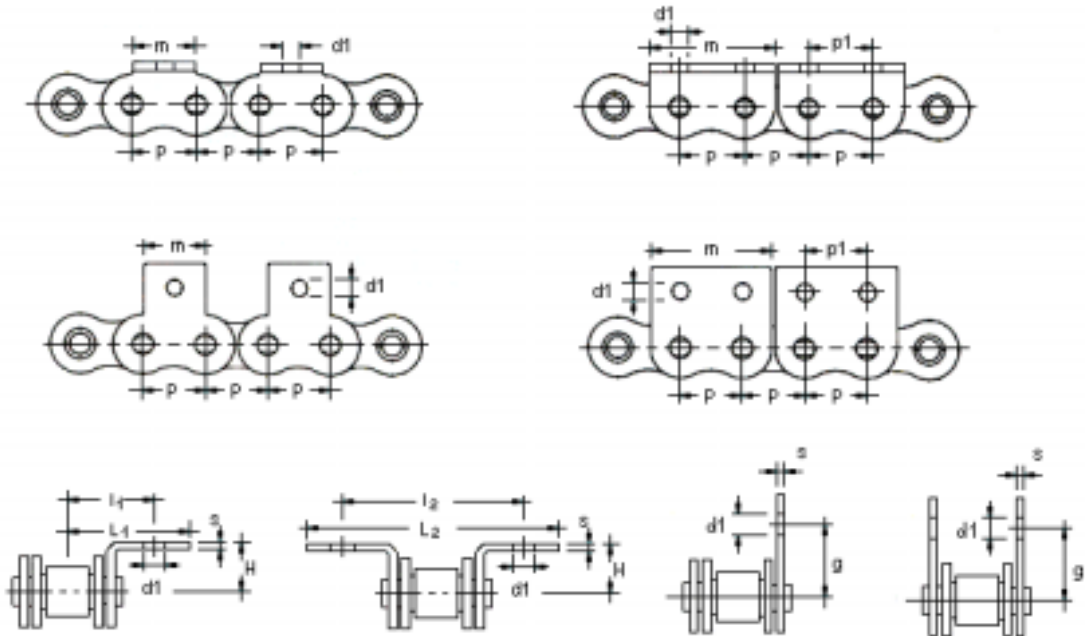

ACCESORIOS NORMALIZADOS DISPONIBLES PARA CADENA 10B (Paso 15,875 mm.)

Ref. Accesorio	Tipo	Nº Taladros	$\varnothing d1$	$p1$	m	H	$l1$	$l2$	$L1$	$L2$	g	s
10B1.41	Recta	1	5,3	--	12,6	--	--	--	--	--	15,88	1,6
10B1.42	Recta	2	5,3	15,87	30	--	--	--	--	--	15,88	1,6
10B1.58	Recta	Ciega	--	--	30	--	--	--	--	--	--	1,6
10B1.61	90°	1	5,3	--	12,6	10,3	15,87	31,75	24,2	48,4	--	1,6
10B1.62	90°	2	5,3	15,87	30	10,3	15,87	31,75	24,2	48,4	--	1,6
10B1.76	90°	1	6,5	--	24	10	17	34	24,6	49,2	--	1,6
10B1.43 AFIL	PINCHO AFILADA		--	--	6	--	--	--	--	--	--	1,6
10B1.43	PINCHO		--	--	6	--	--	--	--	--	--	1,6

CADENAS DE TRANSMISIÓN

Serie ISO Norma Europea DIN 8187

ACCESORIOS DIVERSOS 10B (15,875)

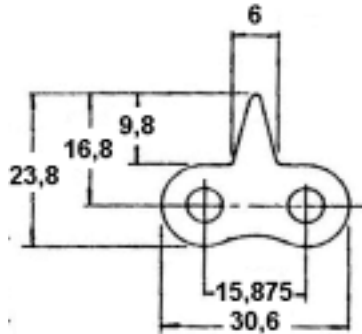

10B1.43

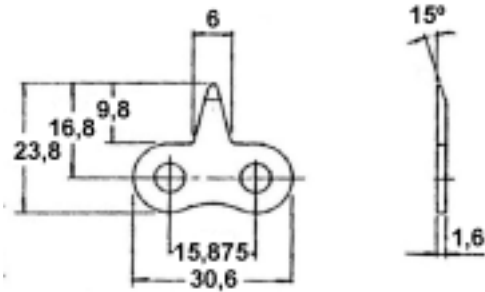

10B1.43 AFILADA

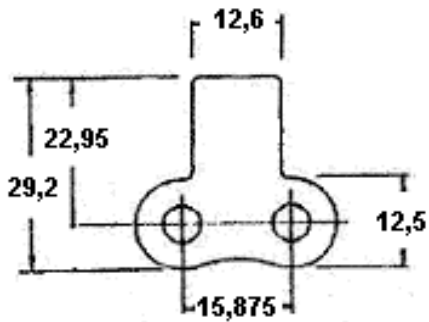

N° 203

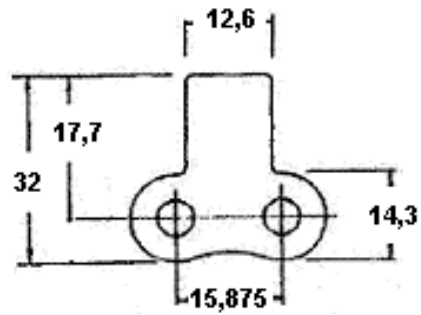

N° 065

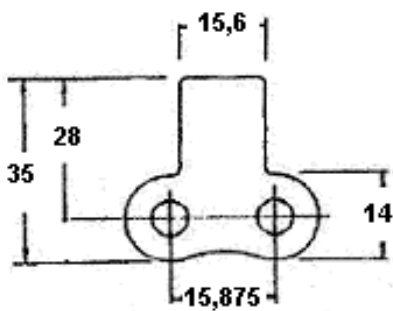

N° 168

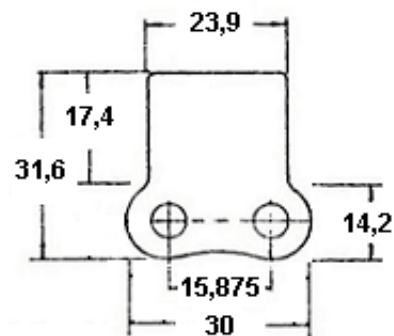

N° 162

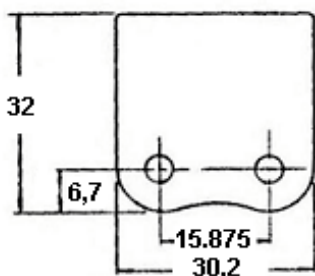

N° 390

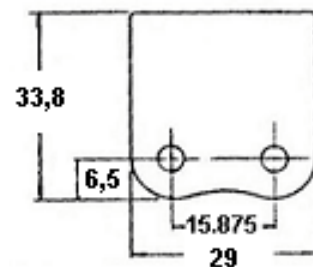

N° 197

CADENAS DE TRANSMISIÓN

Serie ISO Norma Europea DIN 8187
ACCESORIOS DIVERSOS 10B (15,875)

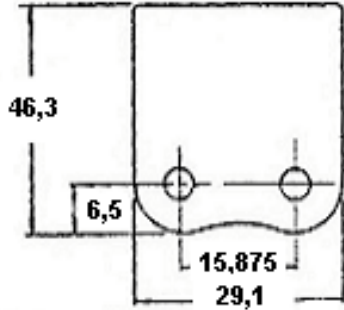

Nº 165

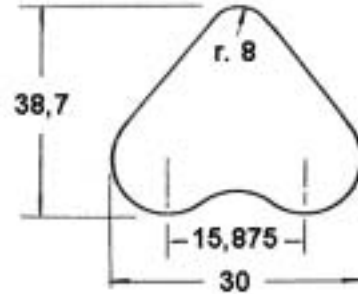

Nº 160

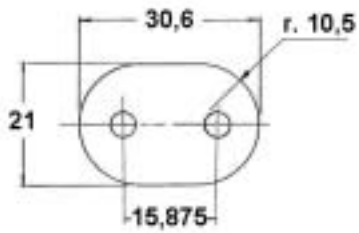

Nº 14273



CADENAS DE TRANSMISIÓN

Serie ISO Norma Europea DIN 8187

ACCESORIOS NORMALIZADOS 12B-1 (19,05)

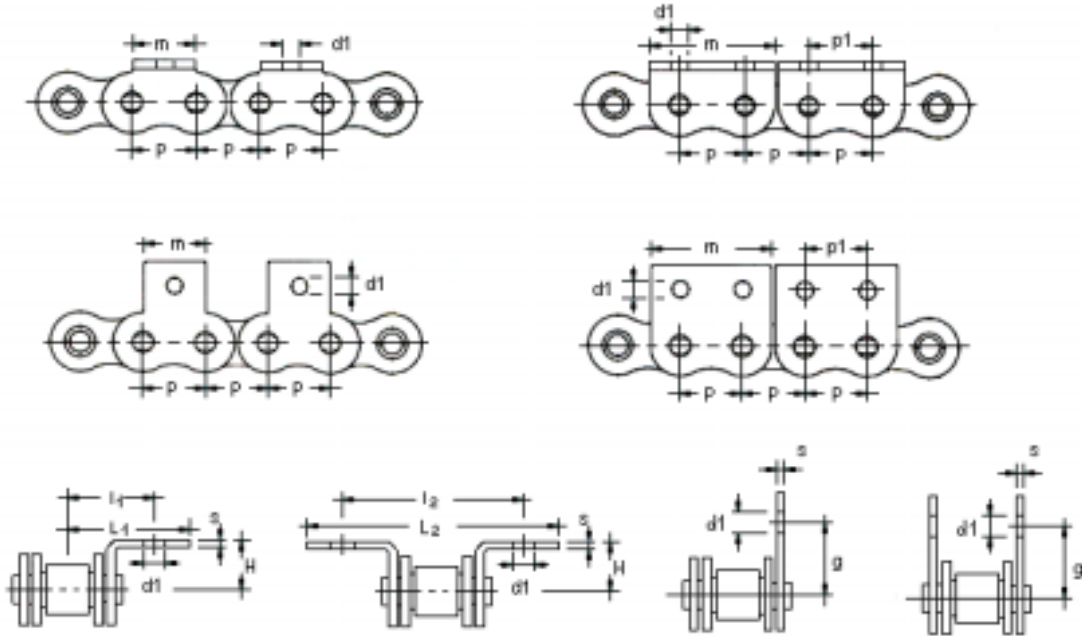

ACCESORIOS NORMALIZADOS DISPONIBLES PARA CADENA 12B (Paso 19,05 mm.)

Ref. Accesorio	Tipo	Nº Taladros	Ø d1	p1	m	H	l1	l2	L1	L2	g	s
12B1.41	Recta	1	6,4	--	15,3	--	--	--	--	--	18,25	1,8
12B1.42	Recta	2	6,4	19,05	34,7	--	--	--	--	--	18,25	1,8
12B1.61	90°	1	6,4	--	15,3	13,5	19,05	38,1	29,15	58,3	--	1,8
12B1.62	90°	2	6,4	19,05	34,7	13,5	19,05	38,1	29,1	58,2	--	1,8
12B1.90	90°	Ciega	--	--	37	12,2	--	--	28	56	--	1,8
12B1.241	Recta	1	9,1	--	19	--	--	--	--	--	18	1,8
12B1.243	90°	Ciega	--	--	19	12	--	--	27,85	55,7	--	1,8
12B1.43	PINCHO 45°		--	--	15,3	--	--	--	--	--	--	1,8
12B1.46	SIERRA		--	--	35	--	--	--	--	--	--	1,8

CADENAS DE TRANSMISIÓN

Serie ISO Norma Europea DIN 8187

ACCESORIOS DIVERSOS 12B (19,05)

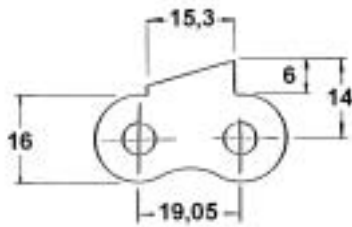

12B1.43

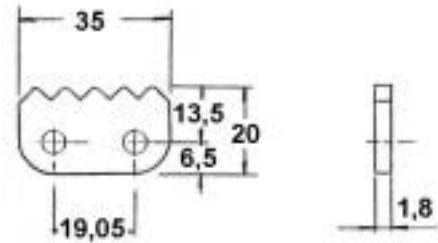

12B1.46

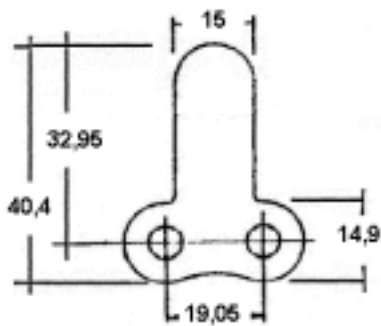

N° 190

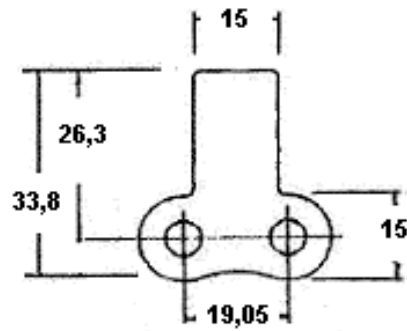

N° 202

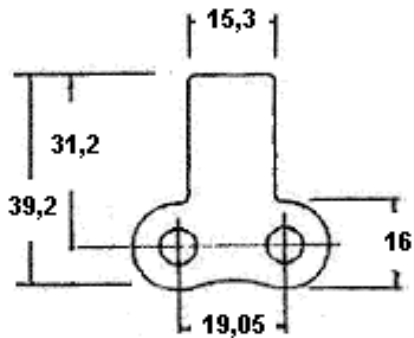

N° 370

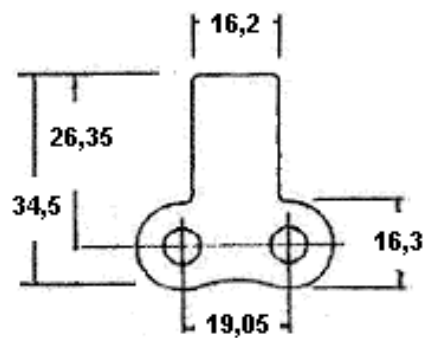

N° 260

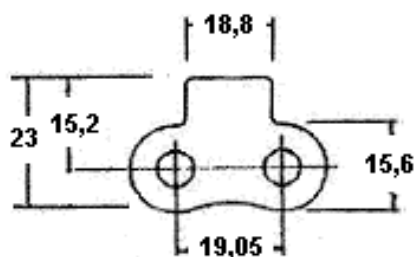

N° 194

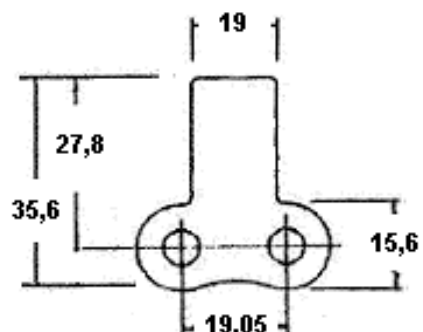

N° 195

CADENAS DE TRANSMISIÓN

Serie ISO Norma Europea DIN 8187

ACCESORIOS DIVERSOS 12B (19,05)

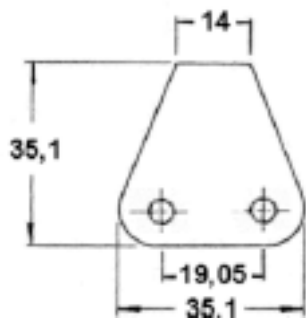

N° 192

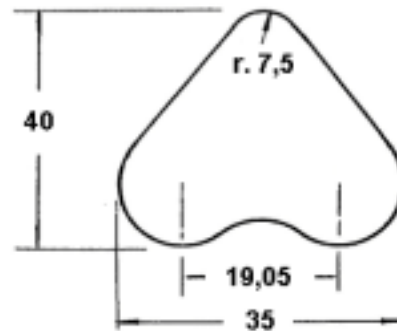

N° 191

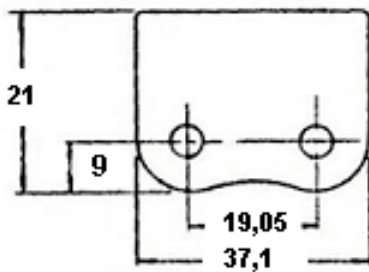

N° 194

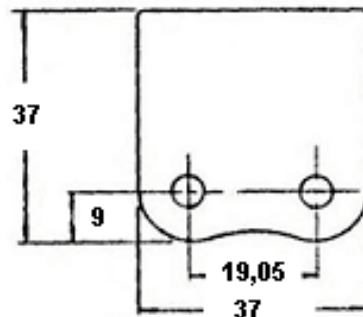

N° 89

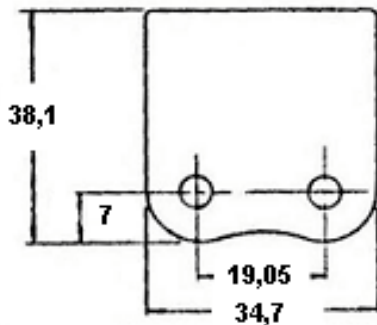

N° 196

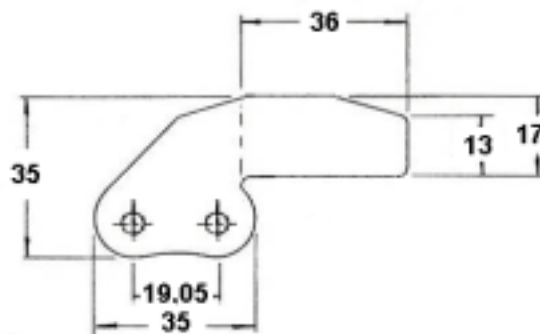

N° 167

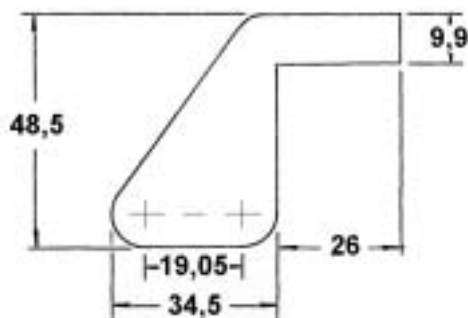

N° 161

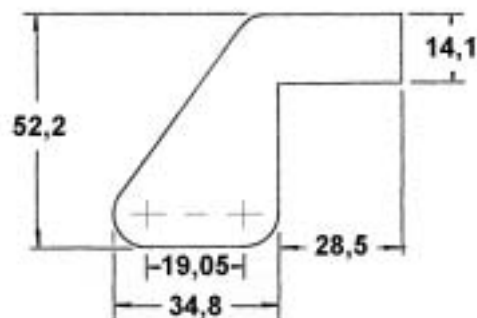

N° 162

CADENAS DE TRANSMISIÓN

Serie ISO Norma Europea DIN 8187
ACCESORIOS DIVERSOS 12B (19,05)

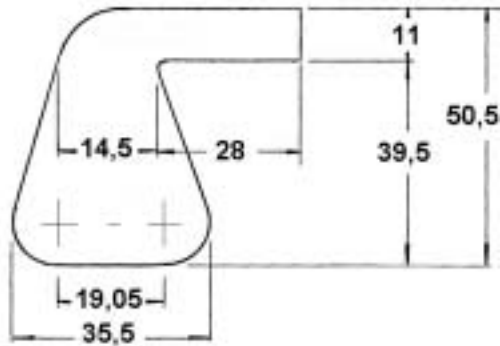

Nº 163

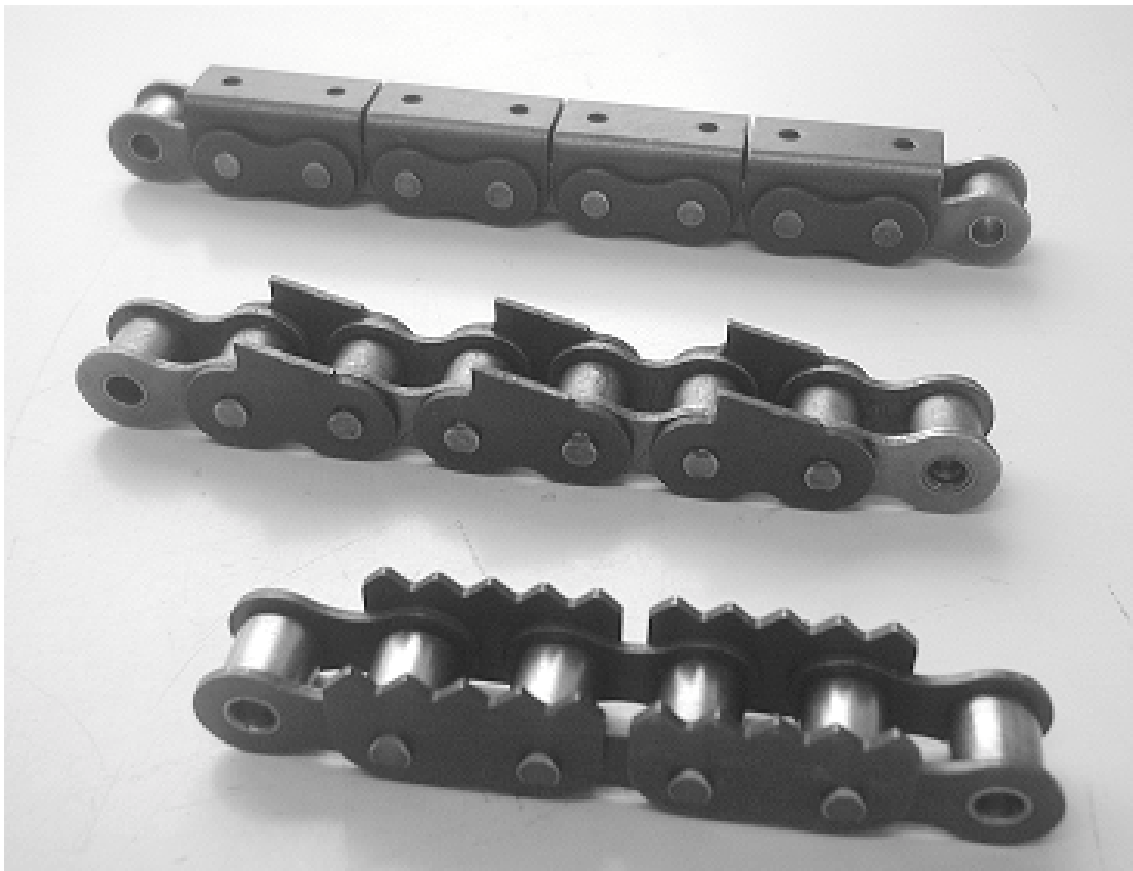

CADENAS DE TRANSMISIÓN

Serie ISO Norma Europea DIN 8187

ACCESORIOS NORMALIZADOS 16B-1 (25,4)

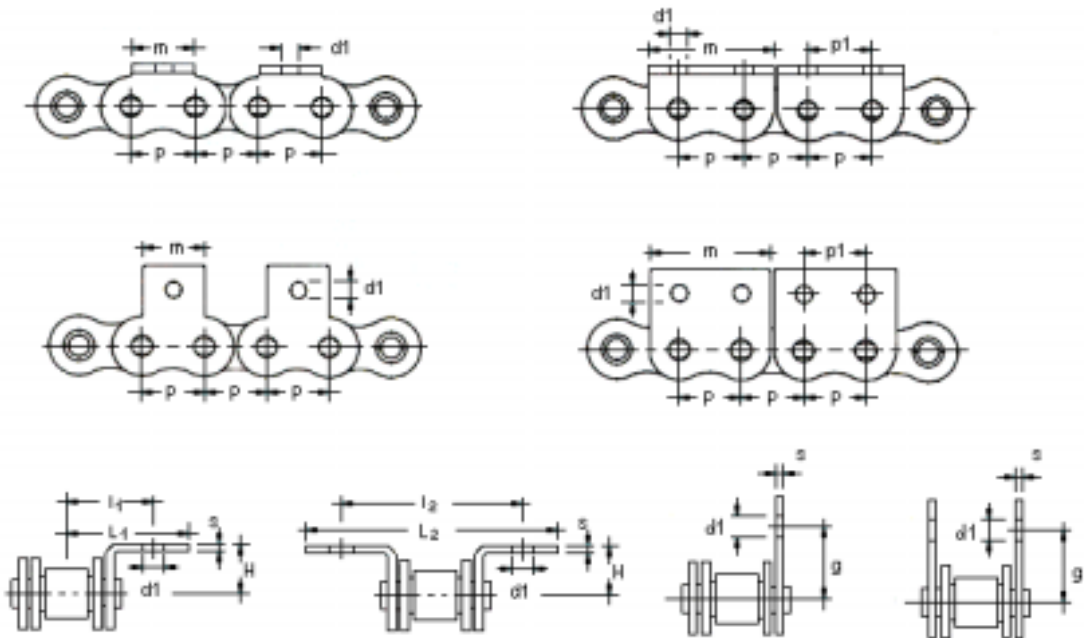

ACCESORIOS NORMALIZADOS DISPONIBLES PARA CADENA 16B (Paso 25,4 mm.)

Ref. Accesorio	Tipo	Nº Taladros	Ø d1	p1	m	H	l1	l2	L1	L2	g	s
16B1.41	Recta	1	8,4	--	20	--	--	--	--	--	24,6	3
16B1.42	Recta	2	8,4	25,4	46,4	--	--	--	--	--	24,6	3
16B1.61	90°	1	8,4	--	20	15,9	25,4	50,8	38,5	77	--	3
16B1.62	90°	2	8,4	25,4	46,4	15,9	25,4	50,8	38,7	77,4	--	3
16B1.331	90°	2	9	25,4	46,8	18	28,95	57,9	41,75	83,5	--	3

CADENAS DE TRANSMISIÓN

Serie ISO Norma Europea DIN 8187

ACCESORIOS DIVERSOS 16B-1 (25,4)

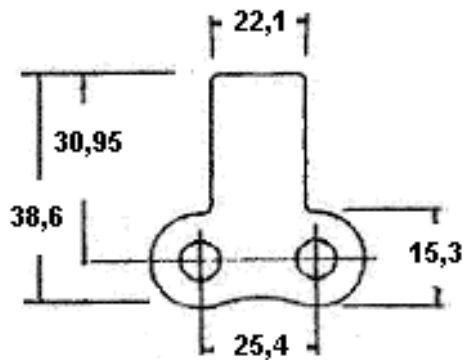

N° 3255

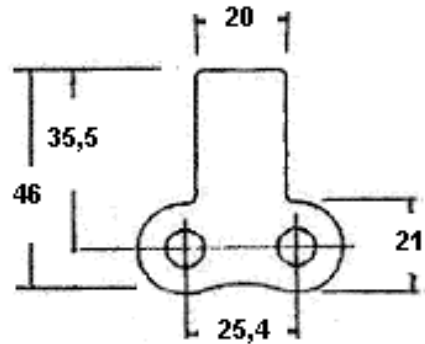

N° 8579

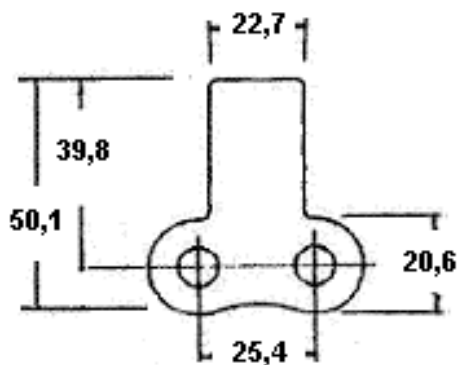

N° 8582

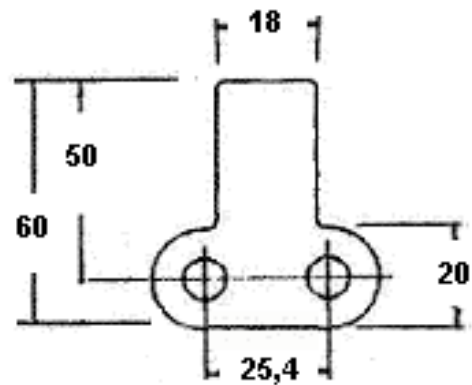

N° 7404

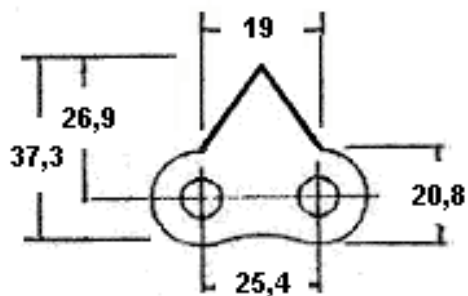

N° 361

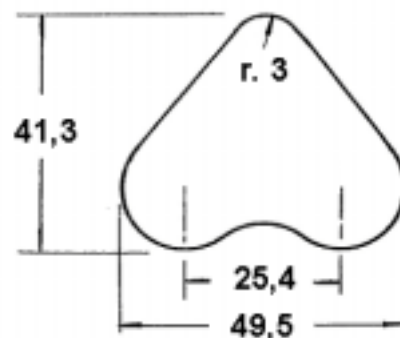

N° 8201

CADENAS DE TRANSMISIÓN

Serie ISO Norma Europea DIN 8187
ACCESORIOS DIVERSOS 16B-1 (25,4)

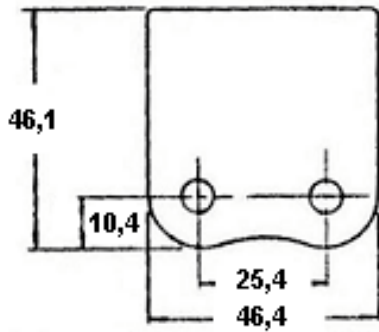

Nº 8581

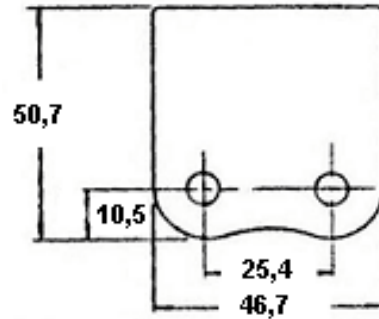

Nº 8580

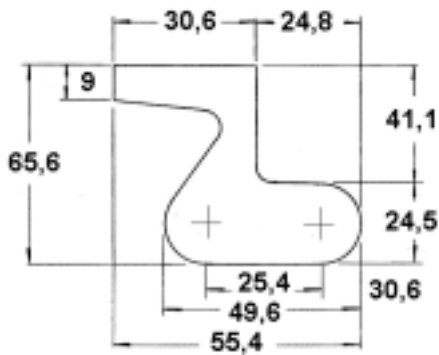

Nº 435

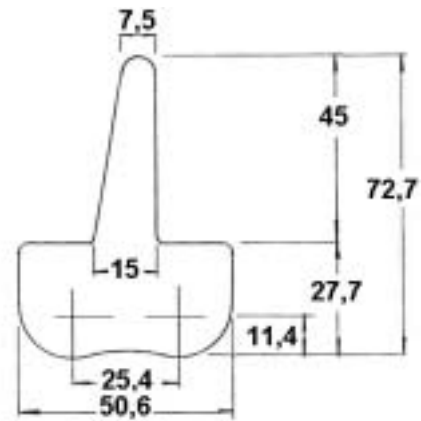

Nº 656



CADENAS DE TRANSMISIÓN

Serie ISO Norma Europea DIN 8187

ACCESORIOS NORMALIZADOS 20B-1 (31,75)

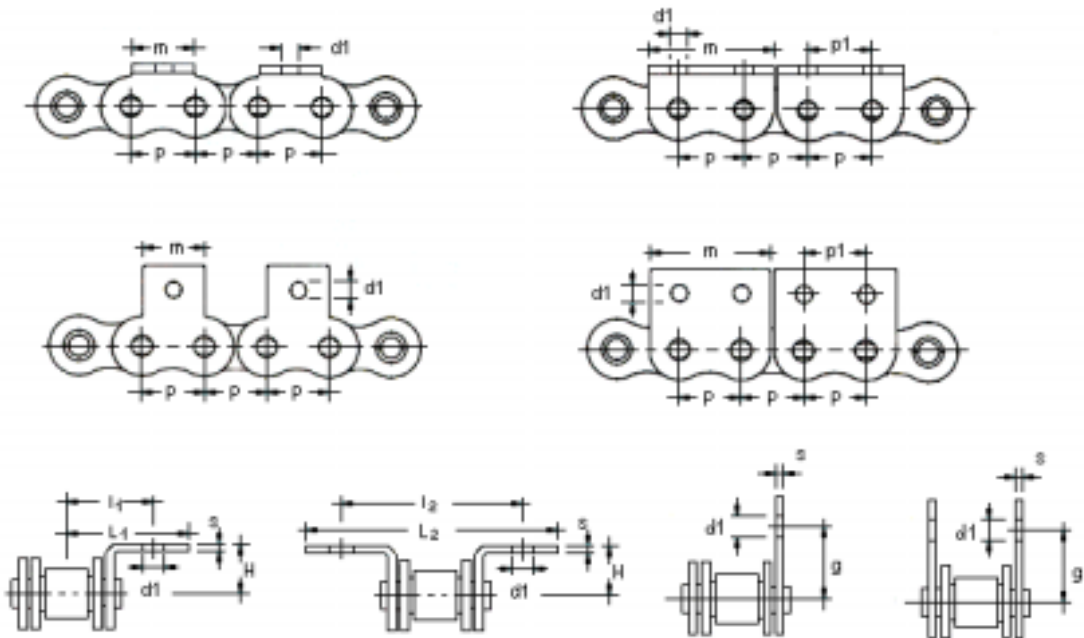

ACCESORIOS NORMALIZADOS DISPONIBLES PARA CADENA 20B (Paso 31,75 mm.)

Ref. Accesorio	Tipo	Nº Taladros	Ø d1	p1	m	H	l1	l2	L1	L2	g	s
20B1.41	Recta	1	8,4	--	25,5	--	--	--	--	--	31,75	3,5
20B1.42	Recta	2	8,4	31,75	57	--	--	--	--	--	31,75	3,5
20B1.61	90°	1	8,4	--	25,5	19,84	31,75	63,5	45,8	91,6	--	3,5
20B1.62	90°	2	8,4	31,75	57	19,84	31,75	63,5	45,8	91,6	--	3,5
20B1.411	90°	2	6,5	16	56	21	42,25	84,5	52,15	104,3	--	4

CADENAS DE TRANSMISIÓN

Serie ISO Norma Europea DIN 8187
ACCESORIOS DIVERSOS 20B-1 (31,75)

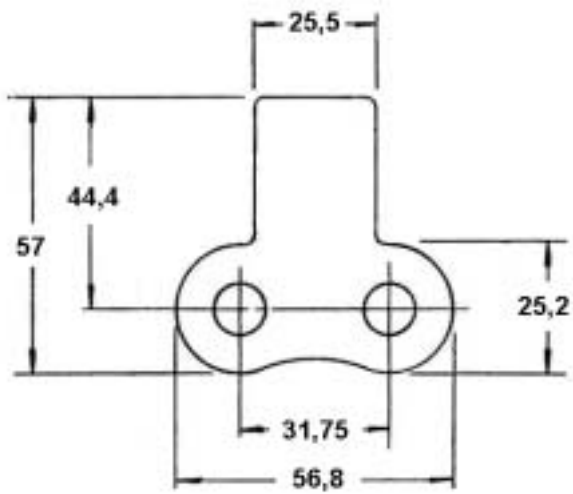

N° 357

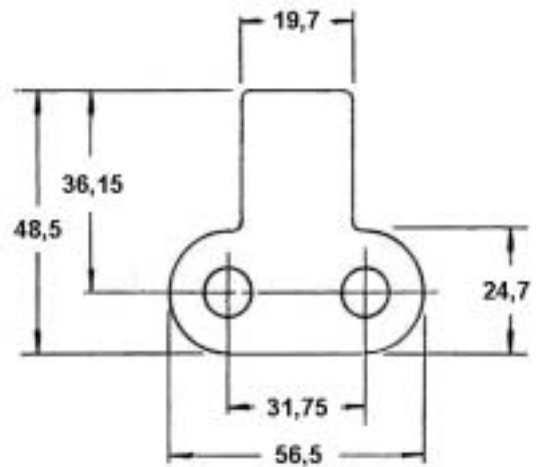

N° 365

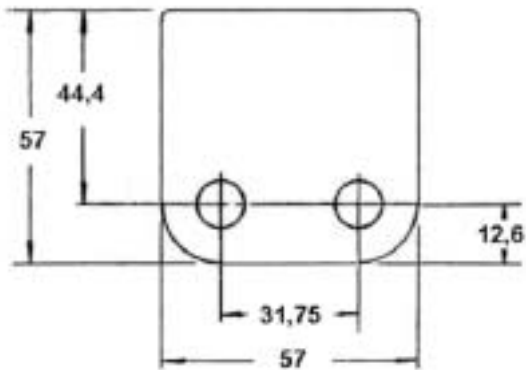

N° 4357

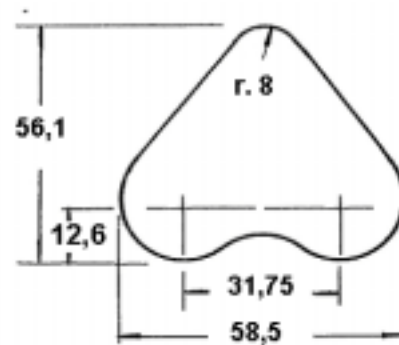

N° 3201

CADENAS DE TRANSMISIÓN

Serie ISO Norma Europea DIN 8187

ACCESORIOS NORMALIZADOS 24B-1 (38,1)

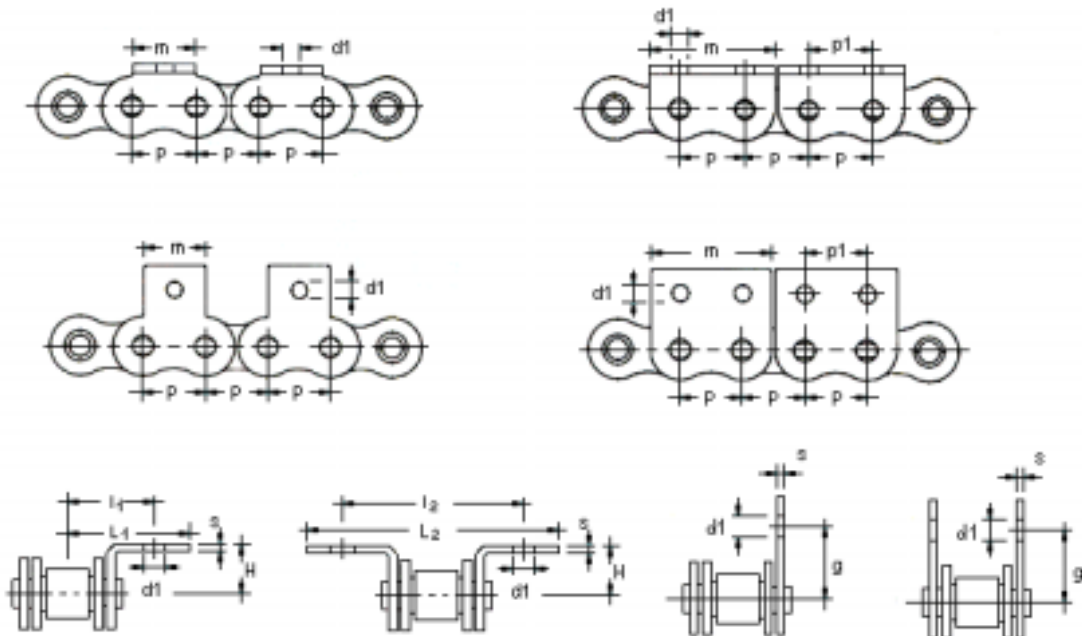

ACCESORIOS NORMALIZADOS DISPONIBLES PARA CADENA 24B (Paso 38,1 mm.)

Ref. Accesorio	Tipo	Nº Taladros	Ø d1	p1	m	H	l1	l2	L1	L2	g	s
24B1.41	Recta	1	10,5	--	30,1	--	--	--	--	--	36,51	5
24B1.42	Recta	2	10,5	38,1	70	--	--	--	--	--	36,51	5
24B1.61	90°	1	10,5	--	30,1	26,7	38,1	76,2	53	106	--	5
24B1.62	90°	2	10,5	38,1	70	26,7	38,1	76,2	52,8	105,6	--	5

CADENAS DE TRANSMISIÓN

Serie ISO Norma Europea DIN 8187

ACCESORIOS DIVERSOS 24B-1 (38,1)

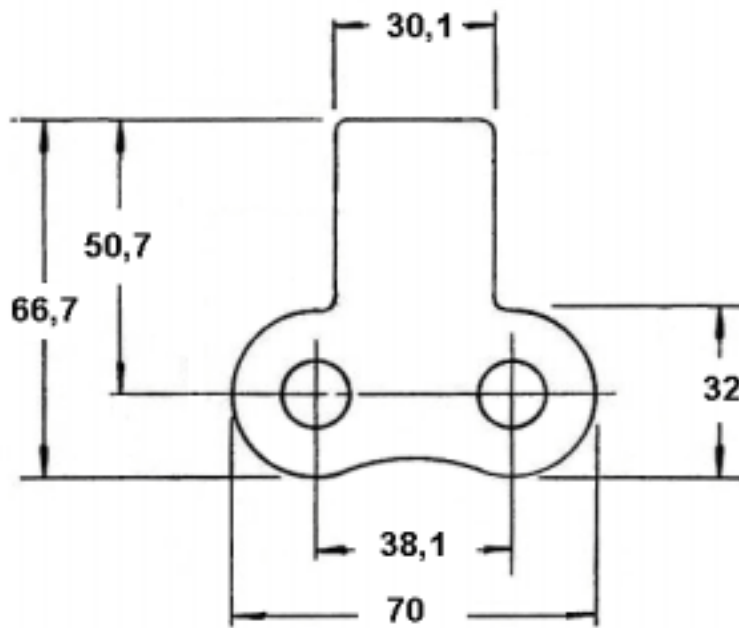

N° 458

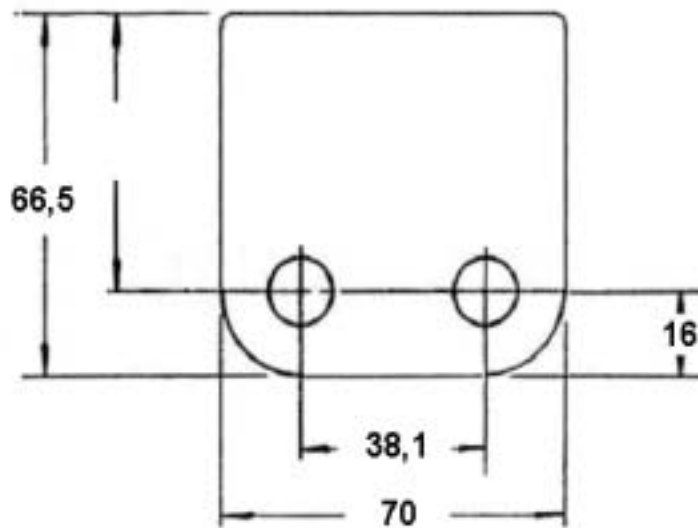

N° 381

CADENAS DE TRANSMISIÓN

Serie ISO - ASA

Flexión Lateral

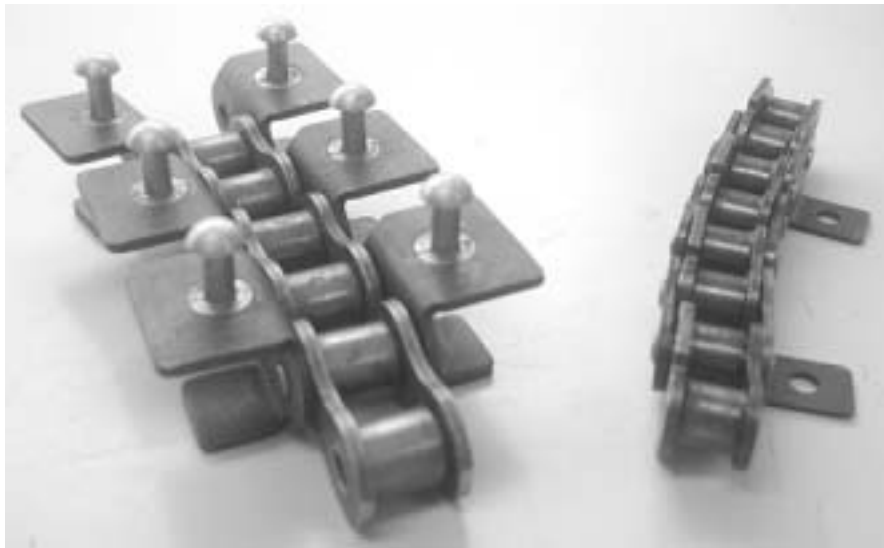
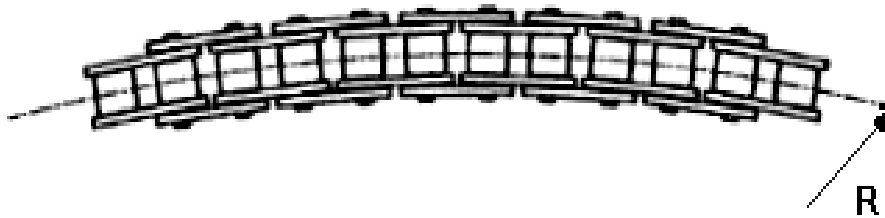
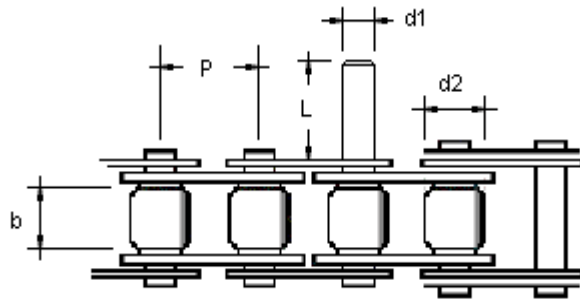

Referencia	PASO (mm.)	PASO (pulg.)	Ancho Interior	Ø Rod.	Longitud Eje	Ø Eje Prolong d1	Carga de Rotura	Radio de Giro
	P	P	b	d2	L		Kp.	R
08B-1	12,7	1/2	7,75	8,51	15	4,45	1500	500
10B-1	15,875	5/8	9,65	10,16	18	5,08	2100	500
12B-1	19,05	3/4	11,68	12,07	21	5,72	2750	800
16B-1	25,4	1 "	17,02	15,87	33	8,27	6100	1200
08A-1	12,7	1/2	7,95	7,95	15,5	3,98	1100	356
10A-1	15,875	5/8	9,53	10,16	19	5,08	2100	406
12A-1	19,05	3/4	12,70	11,91	24	5,94	2750	508
16A-1	25,4	1 "	15,88	15,88	31	7,92	6100	914